

1 Year Warranty

The Manufacturer warrants to the purchaser of this new light that it was thoroughly tested and inspected and found to be in perfect working order before leaving our factory. If within 1 year from the date of purchase, any part of this worklight proves to be defective in material or workmanship, such defective part will be repaired or replaced (company option) free of charge, at our factory. The company's liability in all events is limited to the purchase price paid.

The warranty does not apply to damage, alteration, misuse or abuse not attributed to the Manufacturer, its representatives, dealers or their employees. This warranty does not apply if the product is mishandled or operated at a voltage exceeding, that shown on the product.

The Manufacturer has made a diligent effort to illustrate and describe the products in its literature accurately, however such illustrations and descriptions are for the sole purpose of identification and do not express or imply a warranty that the products will necessarily conform to the illustrations or descriptions.

KEEP THIS MANUAL

If this Worklight malfunctions or is in need of repairs, send to:

CUSTOMER SERVICE DEPARTMENT

1100 S. MORGAN ST.
BLUFFTON, IN 46714
PHONE: (260) 824-3440

FORM # 9032-7303 (01/10)



Available with Scratch
And Chemical Resistant
Outer Tube.



Made In USA

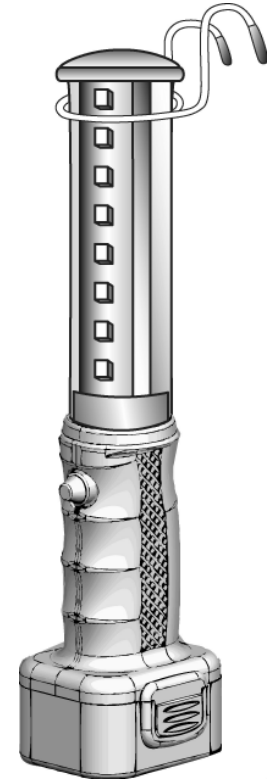

STUBBY II[®]

CORDLESS LED

Warranty & Instruction Manual

Care & Operation of your New Stubby II Cordless LED Worklight

CAUTION

1. Do not submerge in liquids.
2. Caution—Risk of Electrical Shock—Use in Dry Locations Only.
3. Re-charge batteries using the charger provided with the light. Do not attempt to charge the light using a different charger as this may cause damage and will void the warranty.
4. Do not operate the light or battery charger in a hazardous environment containing flammable gases or dust.

OPERATION & MAINTENANCE

1. Use in dry locations only.
2. Unit should operate continuously for 5 hours on fully charged battery.
3. Keep the unit free from grease and dirt by using a damp cloth with mild detergent, or waterless hand cleaners. This removes dirt from scratches in outer tube and will provide the best output at all times. If tube is damaged or badly scratched, it is easily replaced and is available as a replacement part.
4. Do not use solvents such as gasoline to clean unit as it makes the parts brittle. Do not allow brake fluid to contact outer tube as it will cause permanent damage.

CHARGING THE BATTERY

1. The battery has a fuel gauge indicator light that blinks to show the battery charge level. When fully charged the indicator light will blink rapidly, slowing down as the battery charge drops.
Note: the battery has an automatic shut-off feature that will prevent the user from draining the battery down to a point of damage.
2. When the battery charge indicator is blinking slowly, remove the battery from the light fixture. Plug charger jack onto battery charger port as noted on the battery.
3. Indicator light on charger will be red while charging and will turn green when the battery is fully charged.
4. Charger is equipped with a trickle charge feature and will not damage the battery if left connected short term. General Mfg. does not recommend leaving the charger connected to the battery while in storage.
5. Charge batteries in dry locations only.

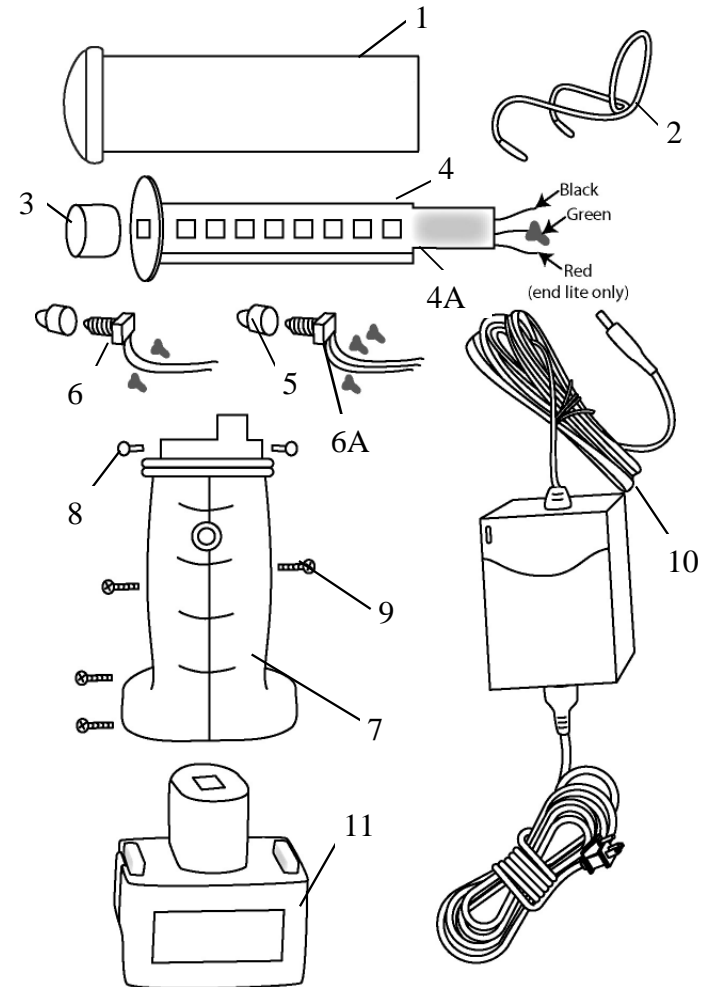

Item	Part No.	Description
1	5000-1429	Outer tube assy- polycarbonate tube. Lens, Reflector, Bumper ring Black
2	5000-0461	Twin spring steel hook with black tips
3	5000-1438	Lense for end lite models only
4	5000-1433	LED board and heat sink with end lite assy
5	5000-0563	Switch boot cover
6	5000-1431	Switch for LED lights with end lite
7	5000-1430	LED light handle
7A	5000-1430A	Half of LED light handle
8	5000-1241	Push pin for outer tube attachment
9	5000-1435	Screw, handle
10	5000-1454	Charger
11	5000-1427	Battery pac